

Colonial Drive Park Final Design

Here is the final design for Colonial Drive Park!

We've prepared a plan and renderings to help visualize the proposed improvements. There is also a link for an interactive 3D model of the playground equipment.

Park improvements include:

- Asphalt paving to improve access into the park.
- Park benches and bike racks for more seating options.
- Deciduous trees for improved shade.
- Concrete pads for waste receptacle and portlet
- Expanded playground equipment.
- Accessible ramp to provide access into the playground area.
- Engineered wood fibre safety surfacing.

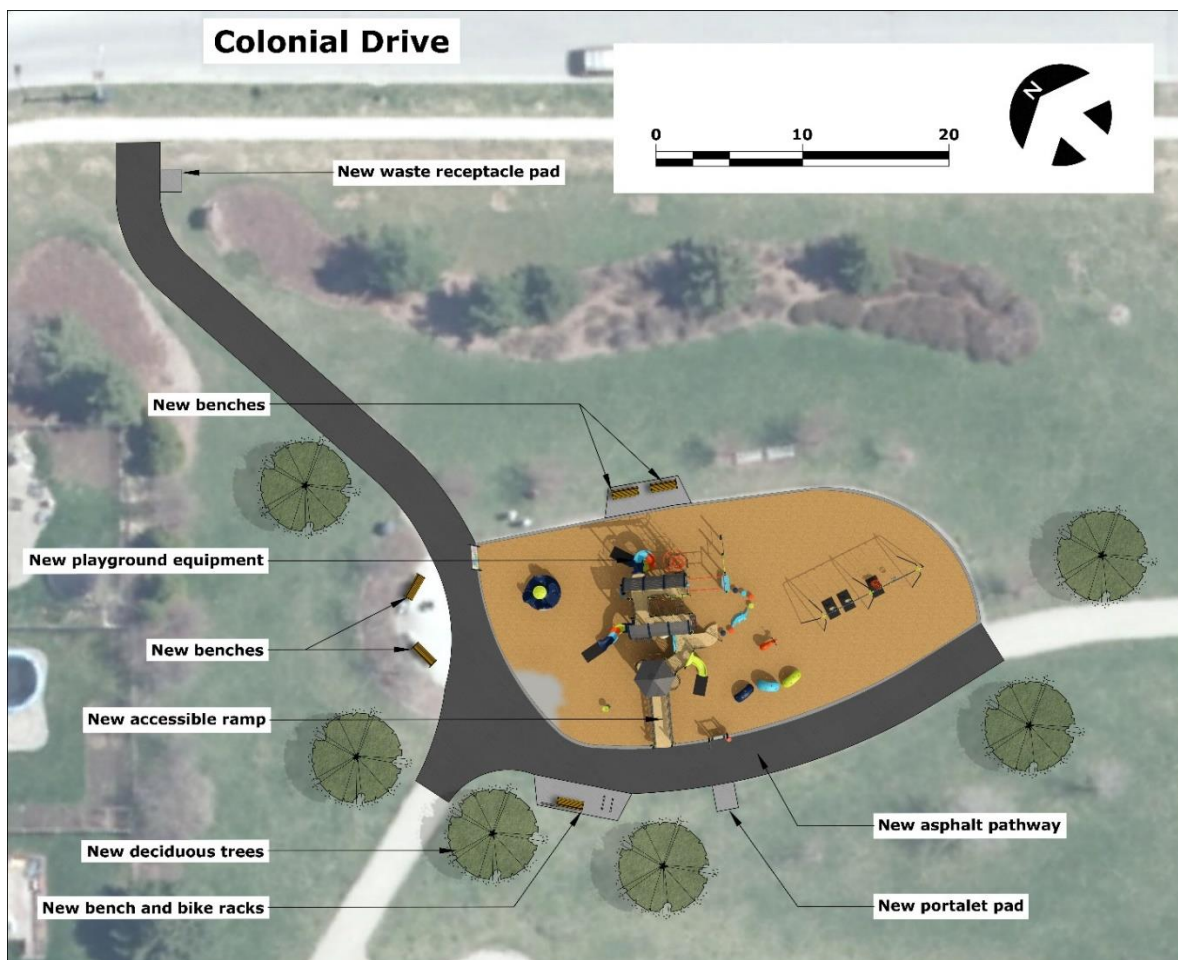

The Playground Equipment includes at grade play elements, a deck play structure and swings.

At grade elements located at the edge of the playground area include:

- Communication Board
- Melody Maker
- Maracas
- Tongue Drum
- Lemonade Stand
- Talk Tube
- Bongo

At grade elements surrounding and integrated within the deck play structure include:

- Revolution Spinner
- Double Hang Out Seats
- Solo Spin
- Tire Climbers
- Stepping Stones
- Therapeutic Rings
- Turning Bar

Elements integrated within the deck play structure include:

- Accessible Ramp with Sensory Rails
- Scrambled Scales Panel
- Living Art Panel
- Disco Party Panel
- Funny Faces Panel
- Seven Station Panel
- Talk Tube
- Mirror Panel
- Monkey Seat Panel
- Quantum Slide
- Pedal Twist Climber
- Spiral Slide

- Silo Climber
- Simon Says Panel
- Sliding Pole
- Tic-Tac-Toe Panel
- Ring Trek Overhead
- Birch Wall Climber
- Telescope Panel
- Accessible Transfer Station
- Elbow Slide

Elements included within the swings include:

- 2 - Belt Swings
- 1 - Tot Swing
- 1 - Accessible Swing

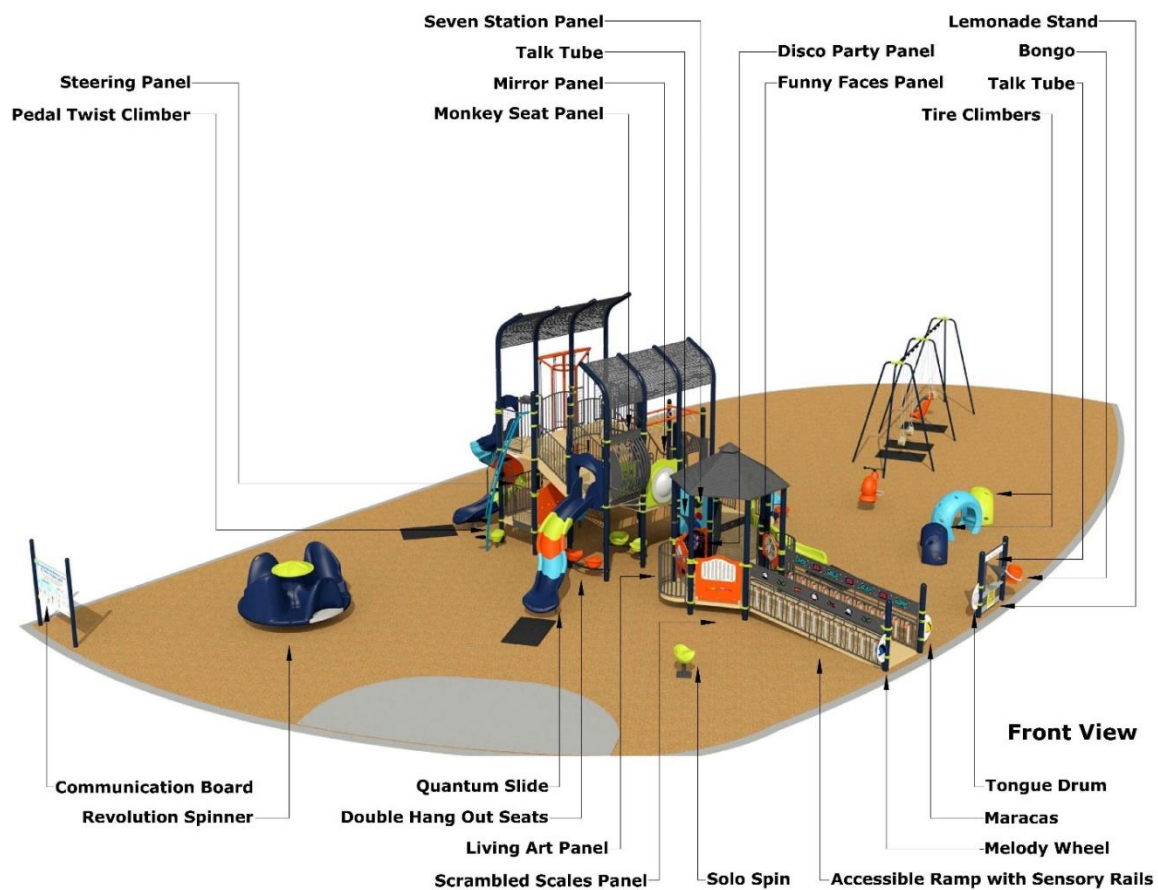

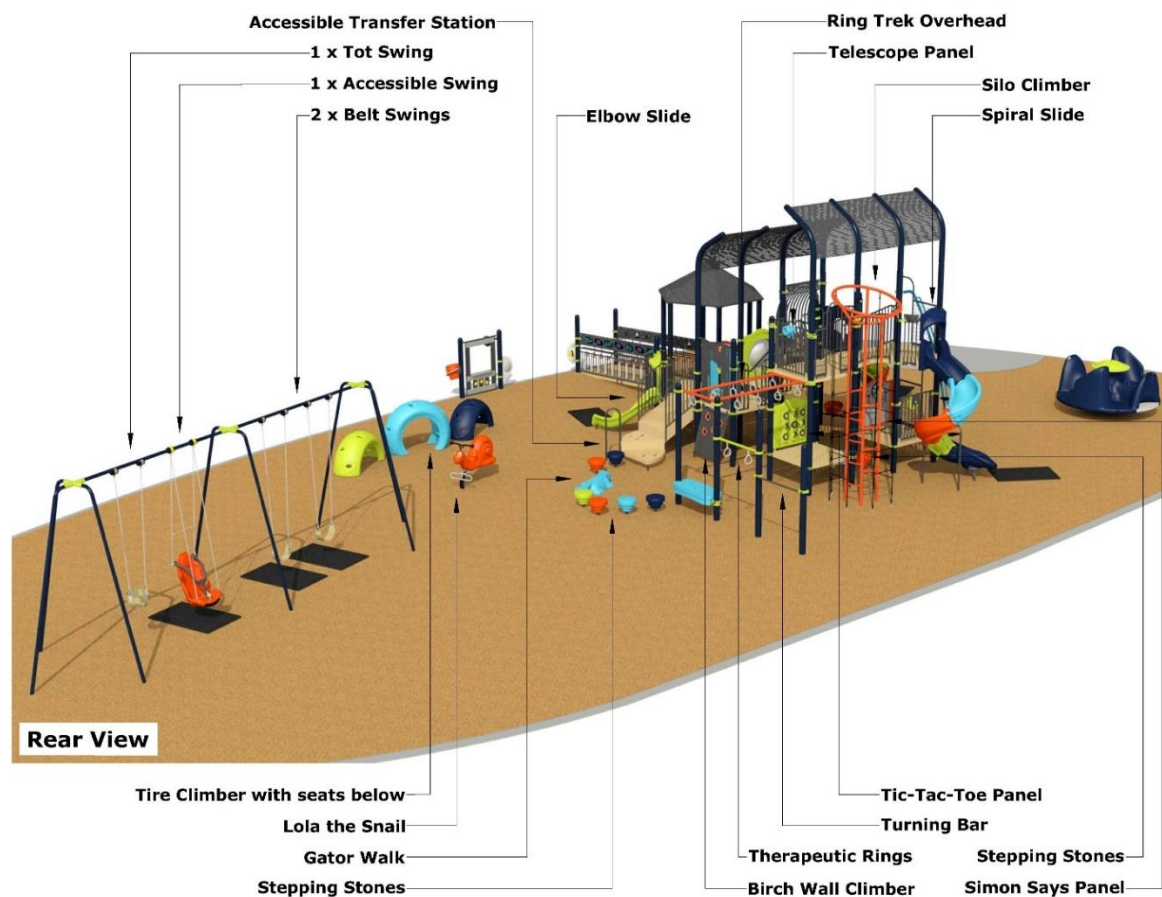

[Click here for an interactive 3D model](#)

For assistance in interacting with the 3D model or an accessible version, please contact:

jude.gaboury@guelph.ca (External link)

519-822-1260 ext. 4121